

Lake County Forestry
601 3rd Avenue
Two Harbors, MN 55616
218-834-8340

“ROCKY ROAD SALE” Timber Appraisal

Tract#: 7 Township: CRYSTAL BAY Public Access /Summer
Legal Description: NW1/4 SW1/4 , Sect. 1, Twp. 57, Rng. 7. SW1/4 NE1/4 , NE1/4 SW1/4 , NW1/4 SW1/4 , NW1/4 SE1/4 , NE1/4 SE1/4 , NW1/4 SE1/4 , Sect. 2, Twp. 57, Rng. 7.

	ASH P&B	49.00	Cords @	2.00 =	98.00
	ASPEN P&B	285.00	Cords @	8.00 =	2280.00
	BALM PULP	24.00	Cords @	3.00 =	72.00
	BIRCH P&B	176.00	Cords @	4.00 =	704.00
#	FIR P&B	182.00	Cords @	3.00 =	546.00
	MAPLE PULP & BOLTS	404.00	Cords @	4.00 =	1616.00
	RED PINE P&B	154.00	Cords @	8.00 =	1232.00
#	SPRUCE P&B	74.00	Cords @	7.00 =	518.00
	WHITE PINE P&B	14.00	Cords @	8.00 =	112.00

Total Acres = 130 39 month sale. \$7,178.00

Sale Administrator: TOM BODELL *Down Payment Required: \$1,076.70*

SUMMER SALE. CLEARCUT. RP THINNING. TOPOGRAPHY: ROLLING. "ROCKY ROAD SALE"

SUSTAINABLE FORESTRY MANAGEMENT GUIDELINES THAT HAVE BEEN DETERMINED TO BE APPROPRIATE FOR THIS SALE ARE EITHER LISTED BELOW/FOUND IN THE CUTTING REGULATIONS ATTACHED/OR DESIGNATED WITH BOUNDARY PAINT ON THE TIMBER SALE.

BLUE PAINT=SALE BOUNDARY RED PAINT=OTHER OWNERSHIP YELLOW PAINT=RESERVE AREA

Regulations

All species Consumer Scale. Special Regulations for this sale on Attached Pages.

Expiration Date: 9/30/2023

Land Commissioner Date

I, _____, hereby agree to and will abide by the terms and conditions set forth in this permit.
 Permittee's Name (Printed)

Permittee	Date
-----------	------

OFFICIAL BID FORM

SEALED BID TIMBER AUCTION LAKE COUNTY DECEMBER 15, 2020

Bid Opening: 10:00 a.m. on Tuesday, December 15, 2020 in the Split Rock River Room, 616 3rd Ave., Two Harbors, MN 55616 (Human Services Bldg.) Special COVID-19 Bidding Options in "Notice of Sealed Bid Timber Auction"

Note to Bidders: A percent bid must be inserted in the appropriate space below. This percent will be applied to each species not designated as a non-bid species. Percent bid should be rounded to the nearest tenth of a percent.

A bid bond, in the form of a check for \$300 made payable to the Lake County Auditor, must be enclosed with your bid. For a successful bidder, the bid bond will be applied to the down payment. Failure to enclose the \$300 bid bond will result in rejection of your bid. (A separate \$300.00 check must be enclosed for each tract bid on.) Successful purchasers will have 10 days to submit the balance of the 15% down payment. Failure to submit the 15% down payment within the allotted time will result in forfeiture of the bid bond.

IF INTERESTED, PLEASE COMPLETE THE BID FORM BELOW

TRACT #	TOTAL APPRAISED TRACT VALUE	BID PERCENTAGE
<u>7</u>	<u>\$7,178.00</u>	<u>%</u>

15% down payment due within 10 days = \$1,076.70

Bidder's Name:			
Address:			
Telephone:			
Bidder's Signature:		Date:	

INSERT BID FORM IN A SEALED ENVELOPE. ENCLOSE \$300 BID BOND WITH BID.

Bids are mailed to:
Clerk of the Board
Lake County Commissioner's Office
601 3rd Avenue
Two Harbors, MN 55616

Envelopes should be marked with "Sealed Bid Auction, December 15, 2020" in the lower left.

Tracts will be awarded to the highest eligible bid submitted

There is no limit on the number of tracts you may bid on, but each bid must have a separate \$300 bid bond check.

TO BE ELIGIBLE TO BID OR TO OPERATE ON COUNTY TIMBER SALES, A "LAKE COUNTY FORESTRY CONTRACTOR APPLICATION", "MN WORKERS COMPENSATION LAW CERTIFICATION OF COMPLIANCE", A "MN DEPARTMENT OF REVENUE - FORM ST3" AND "CERTIFICATION BY LOGGER/CONTRACTOR"

MUST BE ON FILE IN THE LAKE COUNTY FORESTRY OFFICE.
To receive forms call: 218-834-8340



Rocky Road

Forester : T Bodell

Location : 1/2-57-7

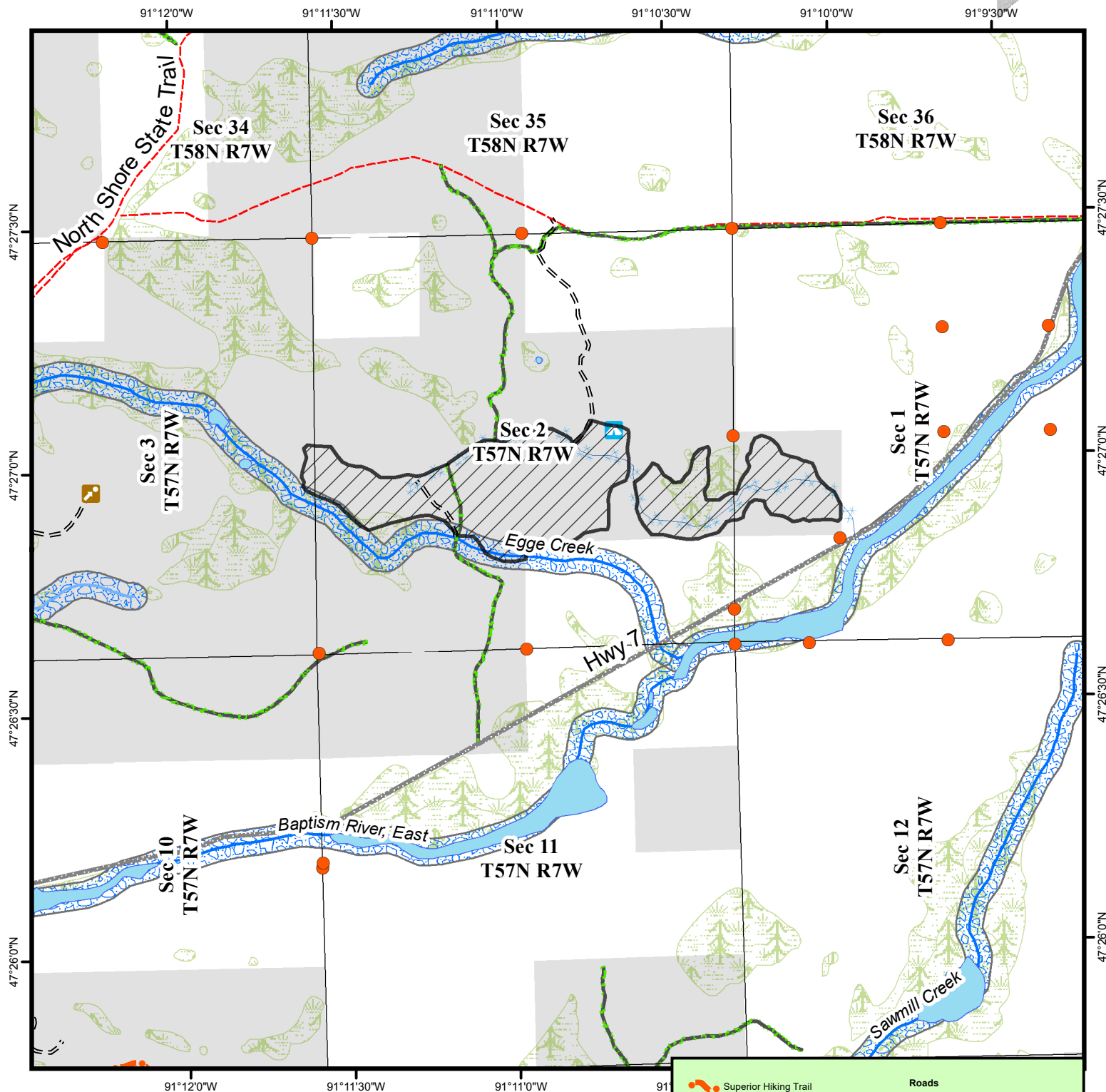

These data are provided on an "AS-IS" basis, without warranty of any type, expressed or implied, including but not limited to any warranty as to their performance, merchantability, or fitness for any particular purpose.

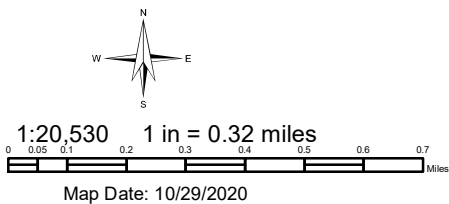

Superior Hiking Trail	Roads Gravel
Proposed Access Road	Low Maintenance Road
Proposed Landings	Recreational
Corners	Winter Only Road
Lake County Timber Sales	National Wetlands Inventory
Section Line	
Cabin Lease	
Lakes	
Designated trout stream	
Designated trout stream tributary	
Not a designated trout stream or tributary	
Trout Stream Buffer	

ROCKY ROAD

Block ID: 4090001 Tract # Block # 1 Administrator: TOM BODELL

SaleID	409	BlockNum	1																																
BlockID	4090001	Acres	130																																
Condition	DIEBACK COMMON IN MAPLE AND BIRCH TOPS. HYPOXYLIN PREVALENT IN POCKETS THROUGHOUT THE TIMBER SALE. ICE STORM DAMAGE SCATTERED THROUGHOUT THE TIMBER SALE AREA. BROKEN TOPPED STAABS AND WIND BENT ASPEN IN POCKETS ACROSS THE TIMBER SALE. DIEBACK COMMON IN ASH TOPS.																																		
Prescription	CLEARCUT ALL SPECIES ACCEPT RED PINE. SELECT CUT RED PINE REMOVING 1/3 OF THE VOLUME. RED PINE TO BE HARVESTED ARE MARKED IN YELLOW PAINT. IF CONVENTIONAL EQUIPTMEENT IS USED CUT 16' WIDE ROWS AND LEAVE 32' BETWEEN ROWS NOT THINNING BETWEEN ROWS.																																		
Harvest Method Equipment	Any	Legal Description <table> <thead> <tr> <th>Tw</th> <th>Range</th> <th>Section</th> <th>Desc</th> </tr> </thead> <tbody> <tr> <td>57</td> <td>7</td> <td>2</td> <td>SWNE</td> </tr> <tr> <td>57</td> <td>7</td> <td>2</td> <td>NESW</td> </tr> <tr> <td>57</td> <td>7</td> <td>2</td> <td>NWSW</td> </tr> <tr> <td>57</td> <td>7</td> <td>2</td> <td>NWSE</td> </tr> <tr> <td>57</td> <td>7</td> <td>2</td> <td>NESE</td> </tr> <tr> <td>57</td> <td>7</td> <td>2</td> <td>NWSE</td> </tr> <tr> <td>57</td> <td>7</td> <td>1</td> <td>NWSW</td> </tr> </tbody> </table>		Tw	Range	Section	Desc	57	7	2	SWNE	57	7	2	NESW	57	7	2	NWSW	57	7	2	NWSE	57	7	2	NESE	57	7	2	NWSE	57	7	1	NWSW
Tw	Range			Section	Desc																														
57	7			2	SWNE																														
57	7			2	NESW																														
57	7			2	NWSW																														
57	7			2	NWSE																														
57	7	2	NESE																																
57	7	2	NWSE																																
57	7	1	NWSW																																
Harvest Method	Clear Cut																																		
Season	Summer																																		
Specified Operating Dates	NA																																		
Bio-Mass Allowed	<input checked="" type="checkbox"/>																																		
Bio-Mass Considerations	RETURN APROXIMATLY 20% OF SLASH SCATTERED EVENLY ACROSS TIMBER SALE.																																		
Sale Boundary Information																																			
AuctionDate:	12/15/2020																																		

Regulations

Regulation	Comment
Balsam fir and white spruce may be left on site and will not be charged for it is not utilized. The unutilized wood from these species will remain standing or be felled and piled, scattered or skidded as determined by the Sale Administrator.	
Retain 2-5 bark on large woody debris (12" or greater, 6' long) per acre by protecting downed trees on site.	
No felling on to adjacent private land	
Leave all snag/nest trees that are not hazards to logging	
Keep out of aspen advanced regeneration	
Reserve all CEDAR, WHITE PINE, AND OAK._____ (list species and or size).	TIMBER SALE IS 23% WINTER. LOWLAND ASH .

ROCKY ROAD

Block ID: 4090001 Tract # Block # 1 Administrator: TOM BODELL

Concentrate slash at landings to promote artifical regeneration UNLESS CUT - TO - LENGTH

Rare and Endangered Species

Riparian Managment Zone (RMZ)

RMZ	RMZ Plan
Designated Trout Stream	165' BUFFER.
Non Trout Stream	50' BUFFER.

Filter Strip Plan

FilterStrip	FilterStripPlan
Non Open-Water Wetland	50' BUFFER

Leave Tree

Leave Tree Species	Strategy	Comment
CEDAR	Retain 5% leave trees by reserve species on sale	
WHITE PINE	Retain 5% leave trees by reserve species on sale	
NORTHERN HARDWOODS	Retain 5% leave trees in scattered individuals	leave 6 - 10 trees per acre.
OAK	Retain 5% leave trees by reserve species on sale	

ROCKY ROAD

Block ID: 4090001 Tract # Block # 1 Administrator: TOM BODELL

Road Plan

Type	Permanent All Season
Public/Private	Public
Length (ft)	5280
Surface Width	14
Clearing Width	30
Stream Crossing	2
Culverts	3
Ice Bridges	
Wooden Bridge	
Ditch Length	400
Closure	APROXIMATLY 7 WATERBARS WILL BE NECESSARY TO INSTALL UPON COMPLETION OF THIS TIMBER SALE.
Lead Off Ditches	
WaterBars	7
Broad Based Dips	
Description	FROM THE INTERSECTION OF CO. RD. # 7 AND THE NEW FOREST RD. LOCATED IN THE NENW, SECTION 11, T. 57 N. - R. 7 W. TRAVEL APROXIMATLY 1/2 MILE NORTH TO EGGE CREEK CROSSING. NEW RD. CONSTRUCTION STARTS ON THE NORTH SIDE OF EGGE CREEK. THE FIRST 1/4 MILE IS NEW ROAD CONSTRUCTION, THE REMAINING 3/4 MILE IS REOPENING AN OLD FOREST ROAD.